

Documents corresponding to the product:

Standard EN 62 208;
EN 60439-1; EN 60 439-3

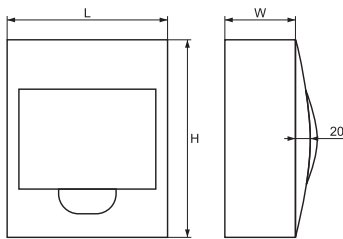

Plastic distribution boxes for surface mounting IP40

The distribution boxes are designed for mounting in newly built buildings or buildings in reconstruction. They are a module box with mounted protective devices of the given flats electrical current circuit circles. They are supplied with transparent door for each row opening upwards to 90°. They are made of white self-extinguishing plastic, resistant to heat and high temperature with IP code: IP 40. The mounted device in the box is protected from direct contact to the current leading parts. They are offered with DIN-rail for device mounting and terminal strips for the neutral and earthing conductor joining. Mounted directly on the walls with screws.

Technical data:

- Maximum insulation voltage: 690V; 50Hz
- fire resistance rate: UL 94
- IP code: IP 40
- Class of current limiting: 2

Number of rows	Module capacity (number of devices)	Terminal strips number	Openings number	Dimensions (mm)			Packing / Box	Catalogue number
				L	H	W		
1	4	2	9	110	205	75	1 / 20	60040
1	6	2	9	150	205	75	1 / 20	60060
1	8	2	14	190	205	75	1 / 20	60080
1	12	3	17	260	205	75	1 / 10	60120
1	18	4	25	365	220	75	1 / 10	60180
2	24	6	34	270	330	75	1 / 10	60240
3	36	8	43	310	475	85	1 / 5	60360

Plastic distribution boxes for flush mounting ip40

The distribution boxes are designed for mounting in newly built buildings or buildings in reconstruction. They are a module box with mounted protective devices of the given flats electrical current circuit circles. They are supplied with transparent door for each row opening upwards to 90°. They are made of white self-extinguishing plastic, resistant to heat and high temperature with IP rate IP 40. The mounted device in the box is protected from direct contact to the current leading parts. They are offered with DIN-rail for device mounting and terminal strips for the neutral and earthing conductor joining. Mounted directly on the walls with screws.

Technical data:

- Maximum insulation voltage: 690V; 50Hz
- fire resistance rate: UL 94
- IP code: IP 40
- Class of current limiting: 2

Number of rows	Module capacity (number of devices)	Terminal strips number	Openings number	Dimensions (mm)			Packing / Box	Catalogue number
				L	H	W		
1	4	2	9	110	205	75	1 / 20	60041
1	6	2	9	150	205	75	1 / 20	60061
1	8	2	14	190	205	75	1 / 20	60081
1	12	3	17	260	205	75	1 / 10	60121
1	18	4	25	365	220	75	1 / 10	60181
2	24	6	34	270	330	75	1 / 10	60241
3	36	8	43	310	475	85	1 / 5	60361

Note: For plasterboard mounting should be used special brackets (4 pcs. set, catalogue number 60085, general packing - 10 sets).

catalogue number 60085





Documents corresponding to the product:

Standard EN 62 208;
EN 60439-1; EN 60 439-3

Moisture-proof distribution boxes for surface mounting - IP 55

The distribution boxes are designed for mounting in newly built buildings or buildings in reconstruction. They are a module box with mounted protective devices of the given flats electrical installation current circles. They are supplied with transparent door for each row opening upwards to 90°. They are made of white non-self-extinguishing plastic, resistant to heat and high temperature. The special design of the lids and gaskets provides IP code: IP 55. The mounted device in the box is protected from indirect contact to the current leading parts. They are offered with DIN-rail for device mounting and terminal strips for the neutral and earthing conductor joining. For direct wall mounting with screws.

Technical data:

- Maximum insulation voltage: 690V; 50Hz
- fire resistance rate: UL 94
- IP code: IP 55
- Class of current limiting: 2

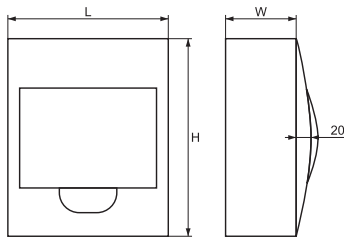

Type	Number of rows	Module capacity (number of devices)	Terminal strips number	Openings number	Dimensions (mm)			Packing / Box	Catalogue number
					L	H	W		
WP4	1	4	2	9	127	214	93	1 / 20	60100
WP6	1	6	2	9	162	214	93	1 / 20	60101
WP8	1	8	2	14	216	214	93	1 / 20	60102
WP12	1	12	3	17	270	214	93	1 / 12	60103
WP18	1	18	4	25	378	233	93	1 / 8	60104
WP24	2	24	6	34	340	288	93	1 / 8	60105