



LT 4-Dxx series contactors are specially designed electromagnetic devices for commutation of three phase induction motor with reversing controlling scheme. They represent two alternating current contactors LT 4-Dxx series factory mechanically joined together. The mechanical joining also provides locking of the contactors against simultaneous switching on. The contactor is used for reverse control of induction motors with shortly joined rotor. The contactors from the series are offered for consumers up to 95A.

- Functions:**
- switching on of electrical motors in one direction of rotation and reversing of the rotation direction at outside command
 - making of control systems
 - remarkable with high reliability of current characteristics
 - reliable switching on or separation of power contacts
 - secured part of the contactors against consumer contact
 - secured cover of the movable part of the contactor
 - impossibility for simultaneous switching on of the two contactors from the group due to mechanical locking

- Technical data:**
- * Operation class: AC 3
 - * Rated operating voltage of the controlling coil: 230V AC, 50/60 Hz
 - * Rated operating voltage of the power circuit: up to 690V AC
 - * Insulation voltage: 690V
 - * Surge voltage wear resistance: >8000V
 - * Limits of the controlling coil voltage: from 0.8 to 1.15 U_c
 - * Number of plugs: 3 NO power contacts +1NO operative (for contactors over 40A there is also additional 1NC contact)
 - * Joining terminal: screw terminal
 - * Connecting:
 - flexible conductors with or without cable terminal
 - rigid conductors

- Note: The contactors are offered without fabric cabling
- * Electrical wear resistance (number of cycles): ≥1 000 000
 - * Mechanical wear resistance (number of cycles): ≥10 000 000
 - * Number of cycles (switching on) per hour: up to 600
 - * Pole making power: up to 13W
 - * Mounting:
 - on DIN-rail or
 - with bolts to the surface
 - mounting position: vertical gradient – maximum ± 5°
 - * Plastic: wear resistance of UV rays and non-flammable (self-extinguishing material)
 - * Ambient temperature: -10°C + 60°C
 - * Altitude: up to 2000m

Type	Overall dimensions (mm)		
	A	B	C
LT 4 - D1810	100	70	83
LT 4 - D2510	130	80	98
LT 4 - D3210	130	80	105
LT 4 - D4011	167	126	116
LT 4 - D6511	167	126	116
LT 4 - D9511	182	127	127

Type	Rated current (A)	Rated capacity of the consumer (kW)					Packing/Box (pcs)	Catalogue number
		230V	400V	415V	440V	690V		
LT 4 D1810	18	4	7.5	7.5	7.5	10	1 / 20	23301
LT 4 D2510	25	5.5	11	11	11	15	1 / 20	23302
LT 4 D3210	32	7.5	15	15	15	18.5	1 / 20	23303
LT 4 D4011	40	11	18.5	18.5	18.5	30	1 / 8	23304
LT 4 D6511	65	18.5	30	30	30	37	1 / 8	23305
LT 4 D9511	95	25	45	45	45	45	1 / 6	23306

Documents corresponding to the product:
Standard EN60947-1; EN 60947-4-1
The products are in accordance with the directives of EC "Low voltage directives (LVD) no. 73/23 EEC" and "Electromagnetic Compatibility Directives (EMC) no. 89/336 EEC"

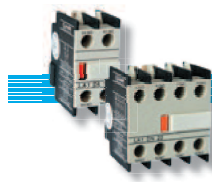
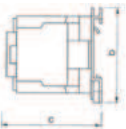
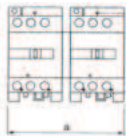

Auxiliary contacts
At necessity the element provide auxiliary number of contacts. They are specially designed for mounting on the movable part of the magnetic core of the contactors LT 1KD series.

- Functions:**
- extending the number of the operative contactors up to 4 in different Combinations
 - switches on simultaneously with the other contact system of the contactor
 - * Operation class: AC 3
 - * Insulation voltage: 690V
 - * Joining terminal: screw terminal
 - * Connecting:
 - flexible conductors with or without cable terminal
 - rigid conductors
 - * Mounting:
 - on the movable cover of the contactor through pinching
 - mounting position: vertical gradient – maximum ± 5°
 - * Plastic: wear resistance of UV rays and non-flammable (self-extinguishing material)

Documents corresponding to the product:
Standard EN 60947-4-1
The products are in accordance with the directives of EC "Low voltage directives (LVD) no. 73/23 EEC" and "Electromagnetic Compatibility Directives (EMC) no. 89/336 EEC"

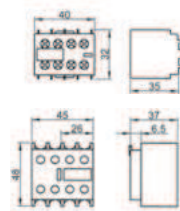

Type	Number of contacts	Catalogue number
LT01-DN02	2NC	23002
LT01-DN11	NO+NC	23011
LT01-DN20	2NO	23020
LT01-DN22	2NO+2NC	23022
LT01-DN40	4NO	23040
LT01-DN04	4NC	23004
LT01-KN11	NO+NC	23001
LT01-KN22	2NO+2NC	23003



Auxiliary contacts LT03-DN11

Providing on necessity additional number of plug points and are mounted sideward to the movable part of the magnetic cores of contactors of the series LT1 D. Variants with two additional plug points NO and NC are offered.

Functions:

- expanding the number of the operational plug points
- switching on simultaneously with the rest of the contact system of the contactor

Technical characteristics:

- * Environment operational regime: AC 3
- * Insulation voltage: 690V
- * Double connector: screw connector
- * Connection:
 - flexible conductors with or without cable end
 - solid conductors
- * Mounting method:
 - mounting position – sideward to the contactor
- * Plastic: resistant to UV and non-burning (self-extinguishing material)

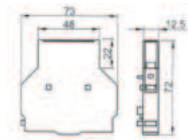

Type	Catalogue number
LT03-DN11	23311



Time delay contact block LT02-Dxx

LT02-Dxx is designed to set time intervals from 0.1 to 180s in different control schemes. It is used most frequently in combination with contactors from LT1-Dxx series to form "star/delta" starters for electrical motor control, as it provides the necessary time for motor winding.

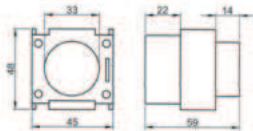

Type	Number of contacts	Time delay	Catalogue number
LT02-DT0	NO+NC	0.1-3s	23901
LT02-DT2	NO+NC	0.1-30s	23902
LT02-DT4	NO+NC	10-180s	23903

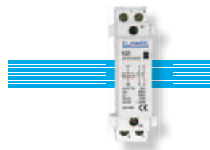

Documents corresponding to the product:

Standard EN 61095
The products are in accordance with the directives of EC "Low voltage directives (LVD) no. 73/23 EEC" and "Electromagnetic Compatibility Directives (EMC) no. 89/336 EEC"

Modular contactors K series are used for commutation of mono-phase and three-phase low power electrical consumers. They provide connection between the consumers in small overall dimensions, silent work, mounting only at DIN-rails.

Functions:

- switching on of consumers
- making of control systems
- remarkable with high reliability of current characteristics
- reliable switching on or separation of power contacts

Technical data:

- * Operation class: AC 7a
- * Rated operating voltage of the controlling coil: 230V AC; 50/60 Hz
- * Rated operating voltage of the power circuit: up to 690V AC
- * Insulation voltage: 690V
- * Surge voltage wear resistance: >8000V
- * Joining terminal: screw terminal
- * Connecting:
 - flexible conductors with or without cable terminal
 - rigid conductors
- * Mounting:
 - on DIN-rail or
 - mounting position: vertical gradient – maximum± 5°
- * Plastic: wear resistance of UV rays and non-flammable (self-extinguishing material)
- * Ambient temperature: -10°C + 60°C
- * Altitude: up to 2000m



Type	In	Coil voltage (V)	Contacts	Packing/Box (pcs)	Catalogue number
K20	20A	230V	2NO	1 / 17 / 170	23008
K20	20A	230V	NO+NC	1 / 17 / 170	23007
K20	20A	230V	2NC	1 / 17 / 170	23009
K40	40A	230V	2NO+2NC	1 / 5 / 50	23422
K40	40A	230V	4NO	1 / 5 / 50	23409

