



Programmable digital one-channel timer TE 20

3 YEAR WARRANTY

The timer is manufactured under the CMOS technology with a quartz minicontroller which makes it reliable for operation. The timer is adjusted for DIN-rail mounting. It is possible to adjust forty-eight ON/OFF cycles. Each program setting is done through selection of the cycle start and end time with the push buttons. When a program is on, the time cycle is indicated as a dimmed out section on the dial. For example, if you start a 2-hour program the 2-hour portion between On and Off times on the dial becomes dark. The minimal interval for cycle programming is 15 minutes. The battery allows programme storing at lack of power supply.

Technical data:

- Power supply voltage: 230V; 50Hz
- Time deviation: <2s (at 25°C)
- Battery for programme storing and operation: up to 150 hours
- Power consumption: <5VA
- Switched on indicator
- Electrical wear resistance: 10⁵ cycles
- Mechanical wear resistance: 10⁷ cycles
- Operating temperature: -10 ÷ +65°C
- Humidity: 35 – 85%RH
- Number of contacts: 1NO + 1NC
- Li-Ion battery: 150h
- Commutating capacity:
 - active load: up to 16A
- Weight: 120g

Mounting:

- DIN-rail

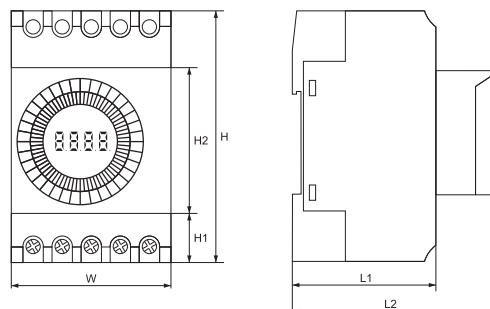

Type	Packing/Box (pcs)	Catalogue number
TE 20	1 / 92	50100

Dimensions (mm)

H	H1	H2	W	L1	L2
85	20	45	54.5	34	66



Tariff switching clock (timer) TE 18

3 YEAR WARRANTY

The timer is adjusted for DIN-rail mounting. It is used for switching on tariff lighting in housing buildings and switching off after the adjusted time. Easy to adjust time intervals, mounting and conducting. Reliable to use.

Technical data:

- Power supply voltage: 230V; 50Hz
- Adjustment range: 0.5 to 20 min
- Power consumption: <2.5VA
- Operating temperature: -5 ÷ +65°C
- Humidity: 45 – 95%RH
- Number of contacts: 1NO
- Commutating capacity:
 - active load: up to 16A
 - inductive load: up to 10 A
- Weight: 75g

Mounting:

- DIN-rail

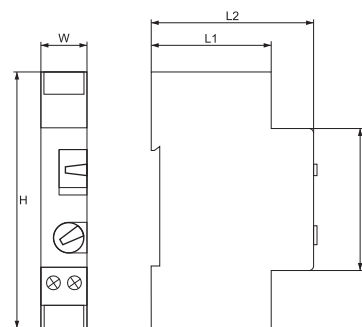

Type	Packing/Box (pcs)	Catalogue number
TE 18	1 / 200	35005

Dimensions (mm)

H	W	L1	L2	D
82	18	40	65	45