

Documents corresponding to the product: Standard EN 61010-1; EN 60044-1; EN 60044-6

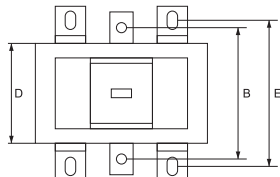
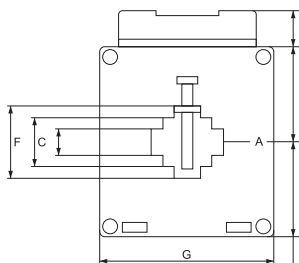

Current measurement transformers MES - xx/xx type

The measurement transformers find application at current measuring, current regulation, systems for current characteristics watching, systems for reactive energy compensation, signaling, etc. They are with x/5 gear ratio as X is the inlet range of the transformer.

Technical data:

- Maximum operating voltage: 720V; 50Hz
- Admissible deviation of the operating current: 1.2 x I_n
- Inlet current: 50 – 1200A
- Outlet current: 5A
- Impulse voltage wear resistance: 4000V; 50Hz (1min)
- Operating temperature: -5-+65°C
- Humidity: 35 – 85%RH
- Precision class: 0.5

Mounting:

- Current transformers can be DIN rail mounted;
- vertically or horizontally to the power supplying rails according to the opening of the transformer
- Current transformers can be mounted on flat surfaces by use of fixing clamps.

Type	Overall dimensions (mm)						
	A	B	C	D	E	F	G
MES - 75/30	88	52	52	41	77	31	31
MES - 75/40	88	52	52	41	77	41	41
MES - 86/60	117	57	57	184	77	61	61

Type	Range	Precision class	Capacity VA	Weight kg	Packing/Box (pcs)	Catalogue number
MES - 75/30	50/5	0.5	1.5	0.60	1 / 40	45050A
MES - 75/30	75/5	0.5	1.5	0.60	1 / 40	45075A
MES - 75/30	100/5	0.5	1.5	0.60	1 / 40	45103A
MES - 75/30	150/5	0.5	2.5	0.60	1 / 40	45153A

Type	Range	Precision class	Capacity VA	Weight kg	Packing/Box (pcs)	Catalogue number
MES - 75/40	200/5	0.5	5	0.60	1 / 40	45204A
MES - 75/40	250/5	0.5	5	0.60	1 / 40	45254A
MES - 75/40	300/5	0.5	10	0.60	1 / 40	45304A
MES - 75/40	400/5	0.5	10	0.60	1 / 40	45404A
MES - 75/40	500/5	0.5	10	0.60	1 / 40	45504A
MES - 75/40	600/5	0.5	15	0.60	1 / 40	45604A

Type	Range	Precision class	Capacity VA	Weight kg	Packing/Box (pcs)	Catalogue number
MES - 86/60	400/5	0.5	15	0.60	1 / 40	45406A
MES - 86/60	500/5	0.5	15	0.60	1 / 40	45506A
MES - 86/60	600/5	0.5	15	0.60	1 / 40	45606A
MES - 86/60	800/5	0.5	15	0.60	1 / 40	45806A
MES - 86/60	1000/5	0.5	15	0.60	1 / 32	45906A
MES - 86/60	1200/5	0.5	15	0.60	1 / 32	45916A