

ProNet

Servo Drives External Dimensions

ProNet-02A/04A/08A/10A/15A

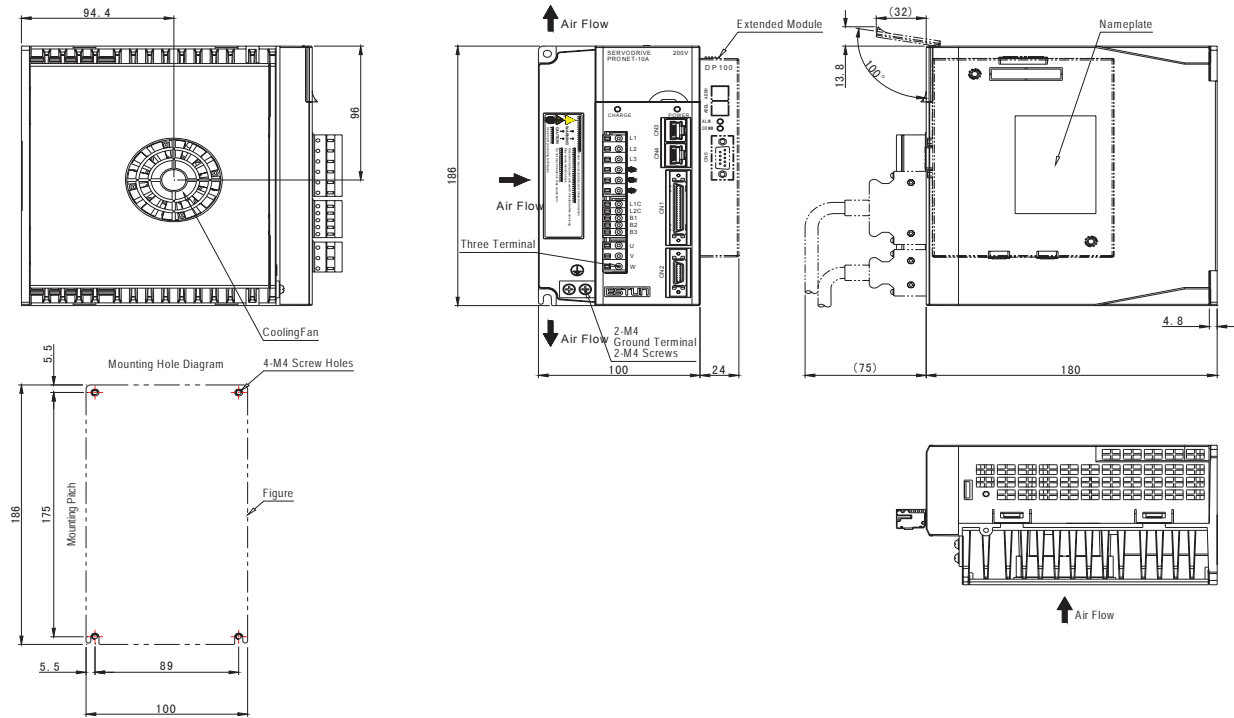

ProNet-20A/30A/50A

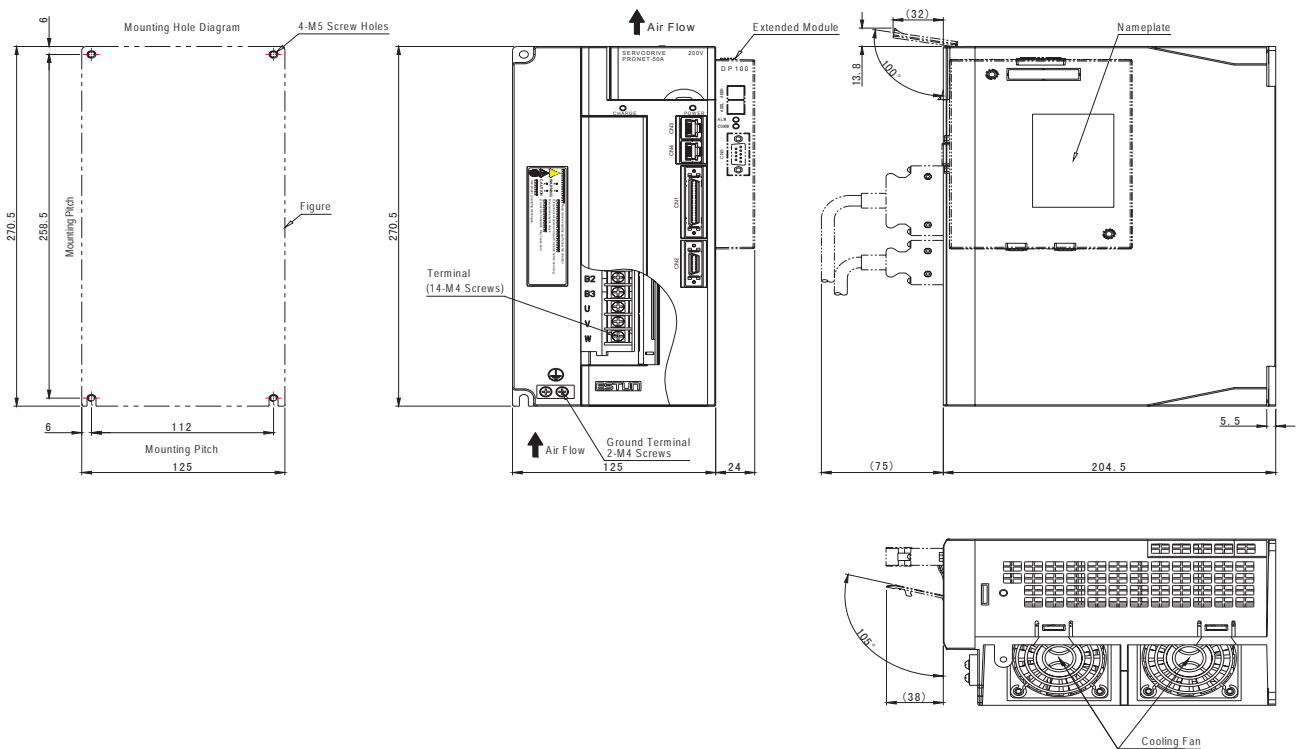

ProNet-75D/1AD/1ED

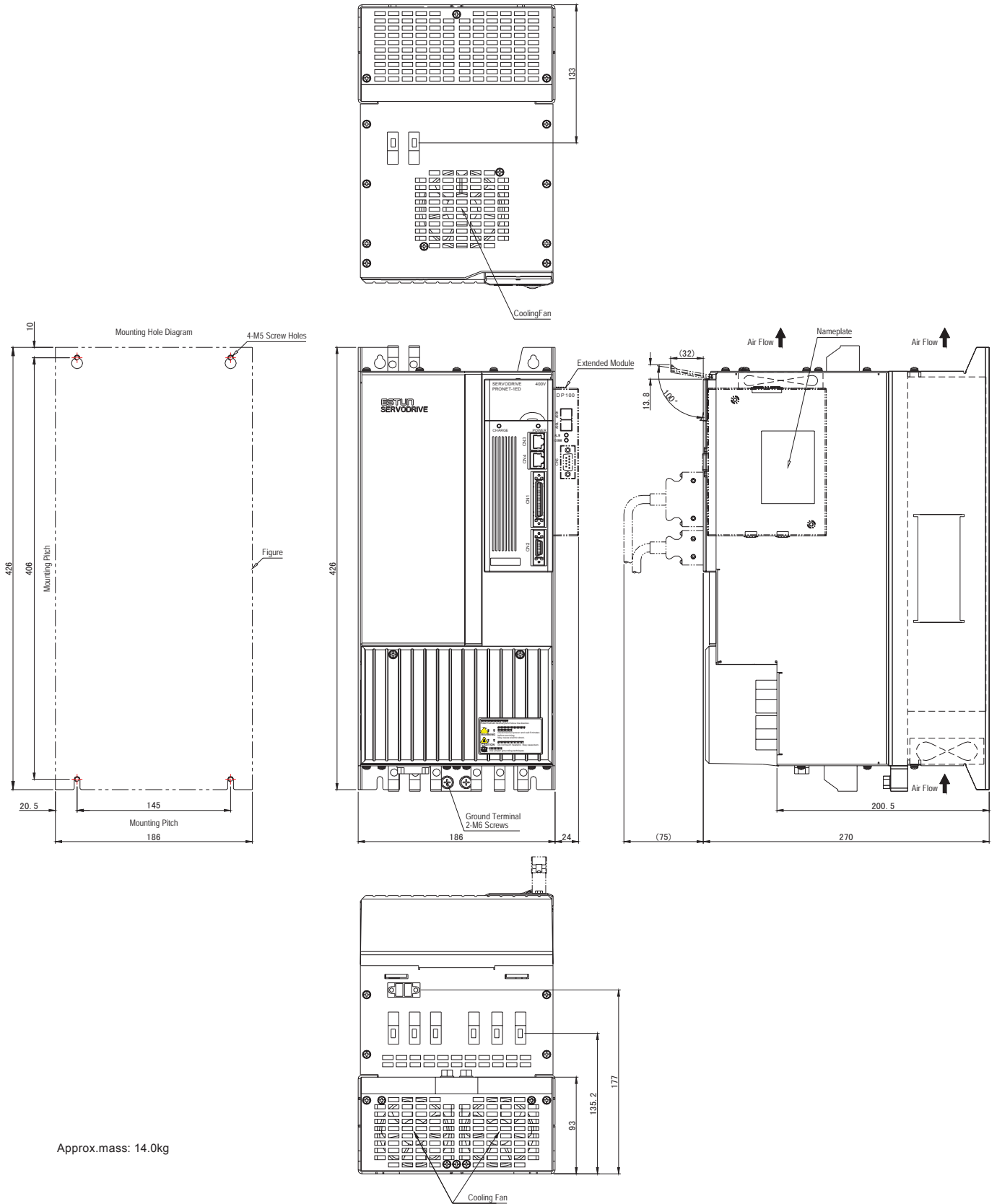

Approx.mass: 14.0kg

ProNet

Typical Connection Example

Three-phase 200VAC (ProNet-10A to 50A)

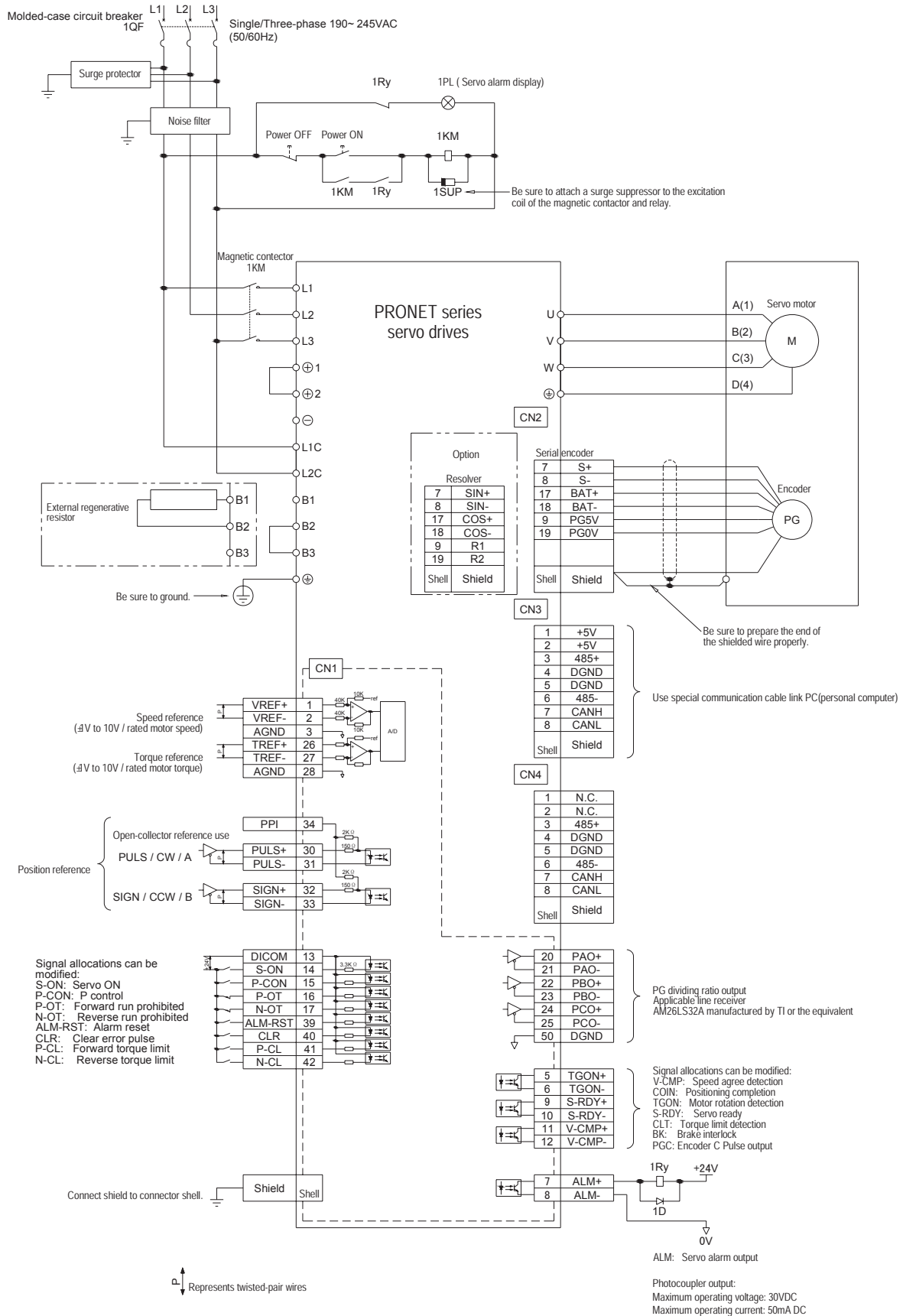

Three-phase 400VAC (ProNet-75D to 1ED)

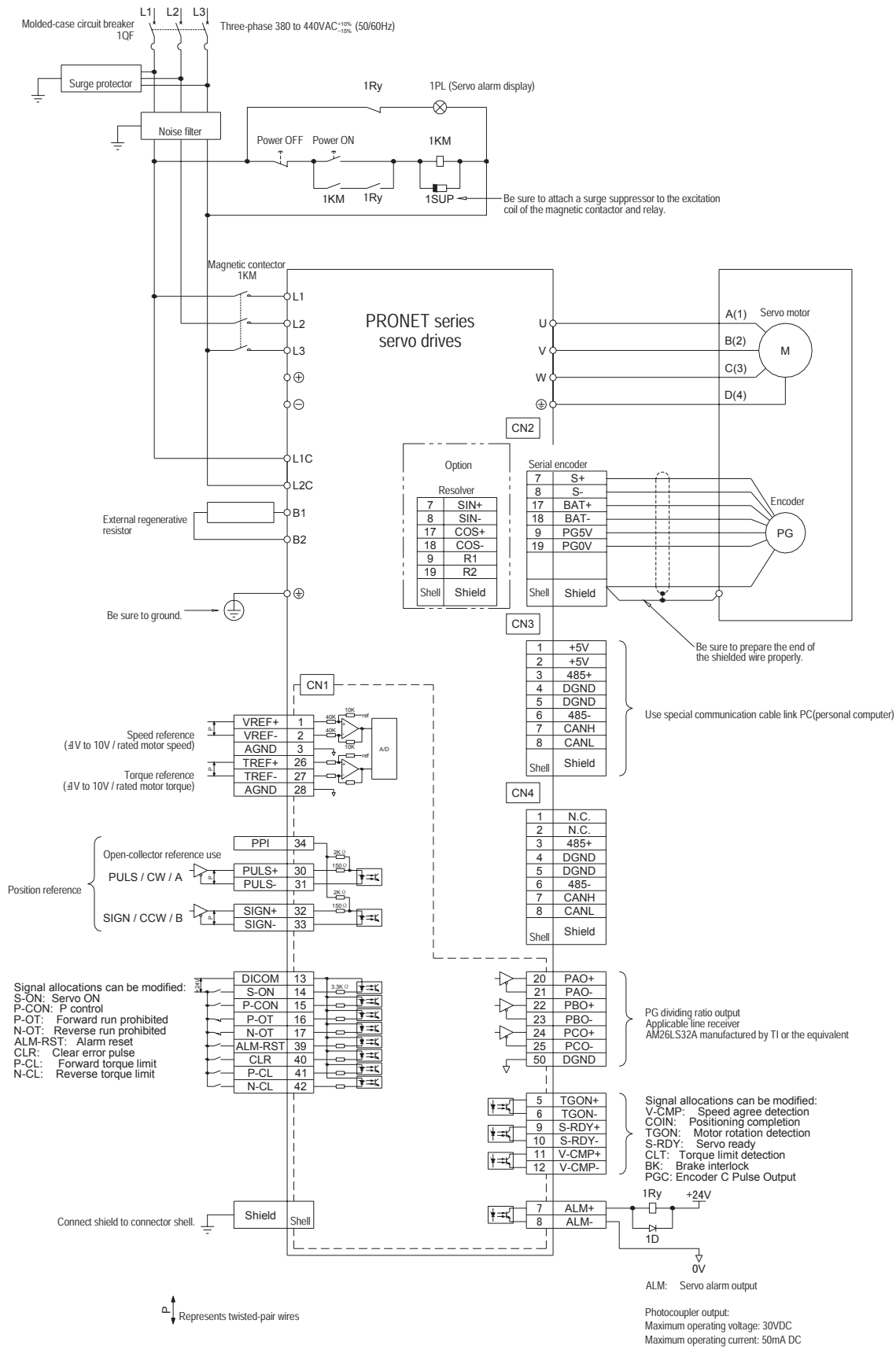

Mission & Vision

Be Backbone Of Industry!

Estun's Brochures and Technical Guidance

- ES2009-A Estun Outline
- ES2009-B Motor Outline
- ES2009-C Estun Sales Agent Training Course
- ES2009-D Estun Servo Parameter Adjustment Guidance
- ES2009-E Second Electronic Gear
- ES2009-F Speed Forward-Feedback Function
- ES2010-A EDB/EDC Series Product Brochure
- ES2010-B ProNet Series Product Brochure**

ESTUN

Estun Automation Technology Co., Ltd.

Add.: 155 Jiangjun Road, Jiangning Development Zone,
Nanjing 211100, P.R. China

Tel: +86-25-52785915 Fax: +86-25-52785576

Website: <http://www.estun-servo.com>

Email: export@estun.com