



### Aludruckguss-Kombischarnier 40

### Die-cast Aluminum Combi Hinge 40

**Beschreibung** nicht aushängbar  
für Flächenelemente und Aluminiumprofile, mit je einem Steckplatz für Zentrierbolzen

**Material** Flügel: Aluminiumdruckguss  
Achse: Edelstahl  
Zentrierbolzen (optional): Kunststoff PA, glasfaserverstärkt

**Oberfläche** alufarbig lackiert

**Befestigung** vorderseitig mit Senkschrauben M6

**Liefereinheit** 10 Stück

**Description** *Non-detachable*  
*To hinge panels or aluminum profiles, each with a hole for centering bolts*

**Material** *Wings: Die-cast-aluminum*  
*Pin: Stainless steel*  
*Centering bolt (optional): Nylon PA, glass fibre reinforced*

**Surface** *Alu color laquered*

**Fastening** *From the front, using M6 countersunk screws*

**Pack Quantity** *10 pieces*

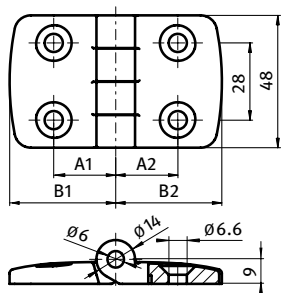

| Scharnier<br>Hinge                 | Bezeichnung<br>Description | A1<br>[mm] | A2<br>[mm] | B1<br>[mm] | B2<br>[mm] | Gewicht [g]<br>Weight [g] | F <sub>Amax</sub><br>[N] | F <sub>Rmax</sub><br>[N] | Teil-Nr.<br>Part # |
|------------------------------------|----------------------------|------------|------------|------------|------------|---------------------------|--------------------------|--------------------------|--------------------|
| nicht aushängbar<br>Non-detachable | 40/40                      | 22.5       | 22.5       | 38.5       | 38.5       | 69.0                      | 250                      | 400                      | 095A4040F          |
|                                    | 40/25                      | 22.5       | 15.0       | 38.5       | 26.0       | 63.0                      | 215                      | 275                      | 095A2540F          |
|                                    | 40/30                      | 22.5       | 17.5       | 38.5       | 29.5       | 67.0                      | 225                      | 325                      | 095A3040F          |
|                                    | 40/35                      | 22.5       | 20.0       | 38.5       | 36.0       | 71.0                      | 225                      | 325                      | 095A3540F          |
|                                    | 40/45                      | 22.5       | 25.0       | 38.5       | 43.5       | 71.0                      | 250                      | 400                      | 095A4045F          |
|                                    | 40/50                      | 22.5       | 27.5       | 38.5       | 48.5       | 74.0                      | 250                      | 400                      | 095A4050F          |
|                                    | 40/60                      | 22.5       | 32.5       | 38.5       | 57.5       | 79.0                      | 100                      | 400                      | 095A4060F          |
| Zentrierbolzen<br>Centering bolt   | Nut 5 Slot 5               | -          | -          | -          | -          | 1.0                       | -                        | -                        | 095AN05            |
|                                    | Nut 6 Slot 6               | -          | -          | -          | -          | 1.0                       | -                        | -                        | 095AN06            |
|                                    | Nut 8 Slot 8               | -          | -          | -          | -          | 1.0                       | -                        | -                        | 095AN08            |
|                                    | Nut 10 Slot 10             | -          | -          | -          | -          | 1.0                       | -                        | -                        | 095AN10            |
|                                    | Nut 12 Slot 12             | -          | -          | -          | -          | 1.0                       | -                        | -                        | 095AN12            |
|                                    | Nut 14 Slot 14             | -          | -          | -          | -          | 1.0                       | -                        | -                        | 095AN14            |