

2K-Klemmhebel

2K Clamp Levers

**NEU
NEW**

Beschreibung mit Außengewinde, Stahl /Edelstahl
zur schnellen, werkzeuglosen Montage und Demontage

Material Griffhebel Hartkomponente:
Kunststoff, glasfaserverstärkt
Griffhebel Weichkomponente:
Thermoflex auf Basis von SEBS
Mechanik: Stahl 5.8 / Edelstahl 1.4305

Oberfläche Mechanik: brüniert / blank

Liefereinheit 10 Stück

Description *with External Thread, Steel / Stainless Steel*
For a quick and safe assembly and disassembly without any need for tools

Material *Hard component:*
Plastics, glass fibre reinforced
Soft component:
Thermoflex, based on SEBS
Mechanics: Steel 5.8 / stainless steel SS 303

Surface *Oxide finish / plain*

Pack Quantity *10 pieces*

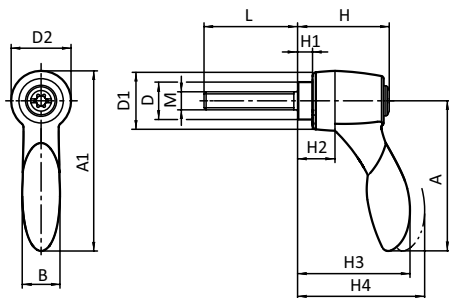

Mechanik <i>Mechanics</i>	Gewinde <i>Thread</i>	D [mm]	D1 [mm]	D2 [mm]	H [mm]	H1 [mm]	H2 [mm]	H3 [mm]	H4 [mm]	A [mm]	A1 [mm]	B [mm]	L [mm]	Teil-Nr. <i>Part N°</i>
Stahl <i>Steel</i>	M5	10.0	15.0	16.0	24.5	4.0	10.0	30.0	33.5	40.1	48.1	10.1	10	041LL040K2KM0510M
	M5	10.0	15.0	16.0	24.5	4.0	10.0	30.0	33.5	40.1	48.1	10.1	15	041LL040K2KM0515M
	M5	10.0	15.0	16.0	24.5	4.0	10.0	30.0	33.5	40.1	48.1	10.1	20	041LL040K2KM0520M
	M5	10.0	15.0	16.0	24.5	4.0	10.0	30.0	33.5	40.1	48.1	10.1	25	041LL040K2KM0525M
	M5	10.0	15.0	16.0	24.5	4.0	10.0	30.0	33.5	40.1	48.1	10.1	30	041LL040K2KM0530M
	M5	10.0	15.0	16.0	24.5	4.0	10.0	30.0	33.5	40.1	48.1	10.1	35	041LL040K2KM0535M
	M5	10.0	15.0	16.0	24.5	4.0	10.0	30.0	33.5	40.1	48.1	10.1	40	041LL040K2KM0540M
	M5	10.0	15.0	16.0	24.5	4.0	10.0	30.0	33.5	40.1	48.1	10.1	45	041LL040K2KM0545M
	M5	10.0	15.0	16.0	24.5	4.0	10.0	30.0	33.5	40.1	48.1	10.1	50	041LL040K2KM0550M
	M6	10.0	15.0	16.0	24.5	4.0	10.0	30.0	33.5	40.1	48.1	10.1	10	041LL040K2KM0610M
	M6	10.0	15.0	16.0	24.5	4.0	10.0	30.0	33.5	40.1	48.1	10.1	15	041LL040K2KM0615M
	M6	10.0	15.0	16.0	24.5	4.0	10.0	30.0	33.5	40.1	48.1	10.1	20	041LL040K2KM0620M
	M6	10.0	15.0	16.0	24.5	4.0	10.0	30.0	33.5	40.1	48.1	10.1	25	041LL040K2KM0625M
	M6	10.0	15.0	16.0	24.5	4.0	10.0	30.0	33.5	40.1	48.1	10.1	30	041LL040K2KM0630M
	M6	10.0	15.0	16.0	24.5	4.0	10.0	30.0	33.5	40.1	48.1	10.1	35	041LL040K2KM0635M
	M6	10.0	15.0	16.0	24.5	4.0	10.0	30.0	33.5	40.1	48.1	10.1	40	041LL040K2KM0640M
	M6	10.0	15.0	16.0	24.5	4.0	10.0	30.0	33.5	40.1	48.1	10.1	45	041LL040K2KM0645M
	M6	10.0	15.0	16.0	24.5	4.0	10.0	30.0	33.5	40.1	48.1	10.1	50	041LL040K2KM0650M
	M6	13.5	17.5	19.0	28.5	6.5	12.5	41.2	45.2	64.9	74.4	17.6	15	041LL065K2KM0615M
	M6	13.5	17.5	19.0	28.5	6.5	12.5	41.2	45.2	64.9	74.4	17.6	20	041LL065K2KM0620M
	M6	13.5	17.5	19.0	28.5	6.5	12.5	41.2	45.2	64.9	74.4	17.6	25	041LL065K2KM0625M
	M6	13.5	17.5	19.0	28.5	6.5	12.5	41.2	45.2	64.9	74.4	17.6	30	041LL065K2KM0630M
	M6	13.5	17.5	19.0	28.5	6.5	12.5	41.2	45.2	64.9	74.4	17.6	35	041LL065K2KM0635M
	M6	13.5	17.5	19.0	28.5	6.5	12.5	41.2	45.2	64.9	74.4	17.6	40	041LL065K2KM0640M
	M6	13.5	17.5	19.0	28.5	6.5	12.5	41.2	45.2	64.9	74.4	17.6	45	041LL065K2KM0645M
	M6	13.5	17.5	19.0	28.5	6.5	12.5	41.2	45.2	64.9	74.4	17.6	50	041LL065K2KM0650M
	M6	13.5	17.5	19.0	28.5	6.5	12.5	41.2	45.2	64.9	74.4	17.6	55	041LL065K2KM0655M
	M6	13.5	17.5	19.0	28.5	6.5	12.5	41.2	45.2	64.9	74.4	17.6	60	041LL065K2KM0660M
	M8	13.5	17.5	19.0	28.5	6.5	12.5	41.2	45.2	64.9	74.4	17.6	15	041LL065K2KM0815M