

OUTPUT SHAFTS

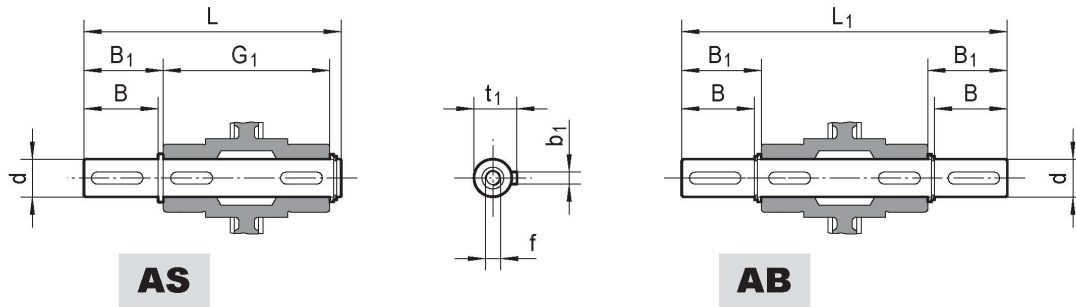

	d h6	B	B ₁	G ₁	L	L ₁	f	b ₁	t ₁
TNRV025	11 _{g6}	23	25.5	50	81	101	—	4	12.5
	9 *	25 *	30 *	50	85.5 *	101	—	3 *	10.2 *
TNRV030	14	30	32.5	63	102	128	M6	5	16
TNRV040	18	40	43	78	128	164	M6	6	20.5
TNRV050	25	50	53.5	92	153	199	M10	8	28
TNRV063	25	50	53.5	112	173	219	M10	8	28
TNRV075	28	60	63.5	120	192	247	M10	8	31
TNRV090	35	80	84.5	140	234	309	M12	10	38
TNRV110	42	80	84.5	155	249	324	M16	12	45
TNRV130	45	80	85	170	265	340	M16	14	48.5

* Only on request

TORQUE ARM

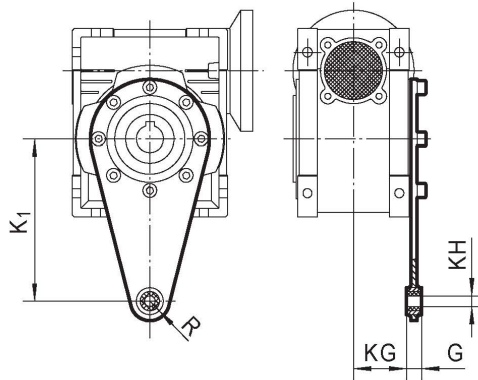

	K ₁	G	KG	KH	R
TNRV025	70	14	17.5	8	15
TNRV030	85	14	24	8	15
TNRV040	100	14	31.5	10	18
TNRV050	100	14	38.5	10	18
TNRV063	150	14	49	10	18
TNRV075	200	25	47.5	20	30
TNRV090	200	25	57.5	20	30
TNRV110	250	30	62	25	35
TNRV130	250	30	69	25	35

COVER

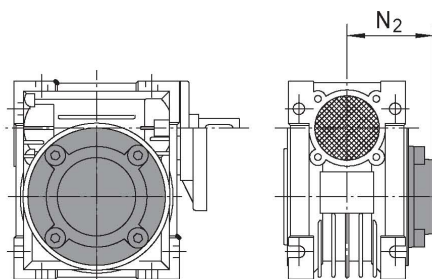

	N ₂		N ₂
TNRV030	47	TNRV075	79
TNRV040	55	TNRV090	94
TNRV050	63	TNRV110	102
TNRV063	73	TNRV130	117